

Application to vary a premises licence under the Licensing Act 2003

PLEASE READ THE FOLLOWING INSTRUCTIONS FIRST

Before completing this form please read the guidance notes at the end of the form. If you are completing this form by hand please write legibly in block capitals. In all cases ensure that your answers are inside the boxes and written in black ink. Use additional sheets if necessary.

You may wish to keep a copy of the completed form for your records.

I/We Greene King Retailing Limited

(Insert name(s) of applicant)

being the premises licence holder, apply to vary a premises licence under section 34 of the Licensing Act 2003 for the premises described in Part 1 below

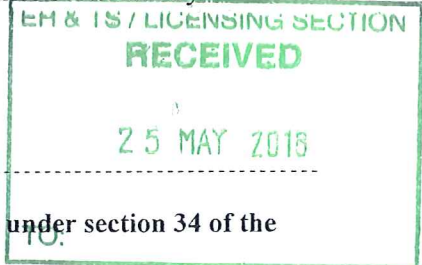

Premises licence number

PR00792

Part 1 – Premises Details

Postal address of premises or, if none, ordnance survey map reference or description

Grandstand
Grandstand Road

Post town

Hereford

Postcode

HR4 0AF

Telephone number at premises (if any)

01432 370867

Non-domestic rateable value of premises

£100,000

Part 2 – Applicant details

Daytime contact telephone number	01284 763222		
E-mail address (optional)	licensing@greeneking.co.uk		
Current postal address if different from premises address	Greene King Retailing Limited Westgate Brewery		
Post town	Bury St Edmunds	Postcode	IP33 1QT

Part 3 - Variation

Please tick as appropriate

Do you want the proposed variation to have effect as soon as possible? Yes No

If not, from what date do you want the variation to take effect?

DD	MM	YYYY

Do you want the proposed variation to have effect in relation to the introduction of the late night levy? (Please see guidance note 1) Yes No

Please describe briefly the nature of the proposed variation (Please see guidance note 2)

To vary the licensing plans to include the following:

- General refurbishment
- Block up existing entrance and relocate to adjacent elevation (which previously contained a main entrance)
- Increase the trading area by removing the internal lobby and partitions

For full and further details please view the licensing plans.

Any part of the variation application that changes the plan/layout at the premises to be of no effect until the work has been completed

If your proposed variation would mean that 5,000 or more people are expected to attend the premises at any one time, please state the number expected to attend:

Part 4 Operating Schedule

Please complete those parts of the Operating Schedule below which would be subject to change if this application to vary is successful.

Provision of regulated entertainment (Please see guidance note 3) Please tick all that apply

- a) plays (if ticking yes, fill in box A)
- b) films (if ticking yes, fill in box B)
- c) indoor sporting events (if ticking yes, fill in box C)
- d) boxing or wrestling entertainment (if ticking yes, fill in box D)
- e) live music (if ticking yes, fill in box E)
- f) recorded music (if ticking yes, fill in box F)
- g) performances of dance (if ticking yes, fill in box G)
- h) anything of a similar description to that falling within (e), (f) or (g) (if ticking yes, fill in box H)

Provision of late night refreshment (if ticking yes, fill in box I)

Supply of alcohol (if ticking yes, fill in box J)

In all cases complete boxes K, L and M

A

Plays Standard days and timings (please read guidance note 8)			Will the performance of a play take place indoors or outdoors or both – please tick (please read guidance note 4)	Indoors	<input type="checkbox"/>
				Outdoors	<input type="checkbox"/>
				Both	<input type="checkbox"/>
Day	Start	Finish	Please give further details here (please read guidance note 5)		
Mon					
Tue					
Wed					
			State any seasonal variations for performing plays (please read guidance note 6)		
Thur			Non standard timings. Where you intend to use the premises for the performance of plays at different times to those listed in the column on the left, please list (please read guidance note 7)		
Fri					
Sat					
Sun					

B

Films Standard days and timings (please read guidance note 8)			Will the exhibition of films take place indoors or outdoors or both – please tick (please read guidance note 4)	Indoors	<input type="checkbox"/>			
				Outdoors	<input type="checkbox"/>			
				Both	<input type="checkbox"/>			
Day	Start	Finish	Please give further details here (please read guidance note 5)					
Mon								
Tue								
Wed						State any seasonal variations for the exhibition of films (please read guidance note 6)		
Thur								
Fri						Non standard timings. Where you intend to use the premises for the exhibition of films at different times to those listed in the column on the left, please list (please read guidance note 7)		
Sat								
Sun								

C

Indoor sporting events Standard days and timings (please read guidance note 8)			Please give further details (please read guidance note 5)
Day	Start	Finish	
Mon			State any seasonal variations for indoor sporting events (please read guidance note 6)
Tue			
Wed			Non standard timings. Where you intend to use the premises for indoor sporting events at different times to those listed in the column on the left, please list (please read guidance note 7)
Thur			
Fri			
Sat			
Sun			

D

Boxing or wrestling entertainments Standard days and timings (please read guidance note 8)			<u>Will the boxing or wrestling entertainment take place indoors or outdoors or both – please tick</u> (please read guidance note 4)	Indoors	<input type="checkbox"/>			
				Outdoors	<input type="checkbox"/>			
				Both	<input type="checkbox"/>			
Day	Start	Finish	<u>Please give further details here</u> (please read guidance note 5)					
Mon								
Tue								
Wed						<u>State any seasonal variations for boxing or wrestling entertainment</u> (please read guidance note 6)		
Thur								
Fri						<u>Non standard timings. Where you intend to use the premises for boxing or wrestling entertainment at different times to those listed in the column on the left, please list</u> (please read guidance note 7)		
Sat								
Sun								

E

Live music Standard days and timings (please read guidance note 8)			Will the performance of live music take place indoors or outdoors or both – please tick (please read guidance note 4)	Indoors	<input type="checkbox"/>			
				Outdoors	<input type="checkbox"/>			
				Both	<input type="checkbox"/>			
Day	Start	Finish	Please give further details here (please read guidance note 5)					
Mon								
Tue								
Wed						State any seasonal variations for the performance of live music (please read guidance note 6)		
Thur								
Fri						Non standard timings. Where you intend to use the premises for the performance of live music at different times to those listed in the column on the left, please list (please read guidance note 7)		
Sat								
Sun								

F

Recorded music Standard days and timings (please read guidance note 8)			<u>Will the playing of recorded music take place indoors or outdoors or both – please tick (please read guidance note 4)</u>	Indoors	<input type="checkbox"/>			
				Outdoors	<input type="checkbox"/>			
				Both	<input type="checkbox"/>			
Day	Start	Finish	<u>Please give further details here (please read guidance note 5)</u>					
Mon								
Tue								
Wed						<u>State any seasonal variations for the playing of recorded music (please read guidance note 6)</u>		
Thur								
Fri						<u>Non standard timings. Where you intend to use the premises for the playing of recorded music at different times to those listed in the column on the left, please list (please read guidance note 7)</u>		
Sat								
Sun								

G

Performances of dance Standard days and timings (please read guidance note 8)			Will the performance of dance take place indoors or outdoors or both – please tick (please read guidance note 4)	Indoors	<input type="checkbox"/>
				Outdoors	<input type="checkbox"/>
Day	Start	Finish		Both	<input type="checkbox"/>
Mon			Please give further details here (please read guidance note 5)		
Tue					
Wed			State any seasonal variations for the performance of dance (please read guidance note 6)		
Thur					
Fri			Non standard timings. Where you intend to use the premises for the performance of dance at different times to those listed in the column on the left, please list (please read guidance note 7)		
Sat					
Sun					

H

Anything of a similar description to that falling within (e), (f) or (g) Standard days and timings (please read guidance note 8)			Please give a description of the type of entertainment you will be providing		
Day	Start	Finish	<u>Will this entertainment take place indoors or outdoors or both – please tick</u> (please read guidance note 4)	Indoors	<input type="checkbox"/>
Mon				Outdoors	<input type="checkbox"/>
				Both	<input type="checkbox"/>
Tue			<u>Please give further details here</u> (please read guidance note 5)		
Wed					
Thur			<u>State any seasonal variations for entertainment of a similar description to that falling within (e), (f) or (g)</u> (please read guidance note 6)		
Fri					
Sat			<u>Non standard timings. Where you intend to use the premises for the entertainment of a similar description to that falling within (e), (f) or (g) at different times to those listed in the column on the left, please list</u> (please read guidance note 7)		
Sun					

I

Late night refreshment Standard days and timings (please read guidance note 8)			<u>Will the provision of late night refreshment take place indoors or outdoors or both – please tick</u> (please read guidance note 4)	Indoors	<input type="checkbox"/>
				Outdoors	<input type="checkbox"/>
				Both	<input type="checkbox"/>
Day	Start	Finish	<u>Please give further details here</u> (please read guidance note 5)		
Mon					
Tue					
Wed			<u>State any seasonal variations for the provision of late night refreshment</u> (please read guidance note 6)		
Thur					
Fri			<u>Non standard timings. Where you intend to use the premises for the provision of late night refreshment at different times, to those listed in the column on the left, please list</u> (please read guidance note 7)		
Sat					
Sun					

J

Supply of alcohol Standard days and timings (please read guidance note 8)			Will the supply of alcohol be for consumption – please tick (please read guidance note 9)	On the premises	<input type="checkbox"/>
				Off the premises	<input type="checkbox"/>
				Both	<input type="checkbox"/>
Day	Start	Finish	State any seasonal variations for the supply of alcohol (please read guidance note 6)		
Mon					
Tue					
Wed					
Thur					
Fri					
Sat					
Sun			Non-standard timings. Where you intend to use the premises for the supply of alcohol at different times to those listed in the column on the left, please list (please read guidance note 7)		

K

<p>Please highlight any adult entertainment or services, activities, other entertainment or matters ancillary to the use of the premises that may give rise to concern in respect of children (please read guidance note 10).</p>
--

L

Hours premises are open to the public Standard days and timings (please read guidance note 8)			<u>State any seasonal variations</u> (please read guidance note 6) <u>Non standard timings. Where you intend the premises to be open to the public at different times from those listed in the column on the left, please list</u> (please read guidance note 7)
Day	Start	Finish	
Mon			
Tue			
Wed			
Thur			
Fri			
Sat			
Sun			

Please identify those conditions currently imposed on the licence which you believe could be removed as a consequence of the proposed variation you are seeking.

Please tick as appropriate

- I have enclosed the premises licence
- I have enclosed the relevant part of the premises licence

If you have not ticked one of these boxes, please fill in reasons for not including the licence or part of it below

Reasons why I have not enclosed the premises licence or relevant part of premises licence.

M Describe any additional steps you intend to take to promote the four licensing objectives as a result of the proposed variation:

a) General – all four licensing objectives (b, c, d and e) (please read guidance note 11)

As per premises licence granted

b) The prevention of crime and disorder

As per premises licence granted

c) Public safety

As per premises licence granted

d) The prevention of public nuisance

As per premises licence granted

e) The protection of children from harm

As per premises licence granted

Checklist:

Please tick to indicate agreement

- I have made or enclosed payment of the fee; or
- I have not made or enclosed payment of the fee because this application has been made in relation to the introduction of the late night levy.
- I have sent copies of this application and the plan to responsible authorities and others where applicable.
- I understand that I must now advertise my application.
- I have enclosed the premises licence or relevant part of it or explanation.
- I understand that if I do not comply with the above requirements my application will be rejected.

IT IS AN OFFENCE, UNDER SECTION 158 OF THE LICENSING ACT 2003, TO MAKE A FALSE STATEMENT IN OR IN CONNECTION WITH THIS APPLICATION. THOSE WHO MAKE A FALSE STATEMENT MAY BE LIABLE ON SUMMARY CONVICTION TO A FINE OF ANY AMOUNT.

Part 5 – Signatures (please read guidance note 12)

Signature of applicant (the current premises licence holder) or applicant’s solicitor or other duly authorised agent (please read guidance note 13). **If signing on behalf of the applicant,**

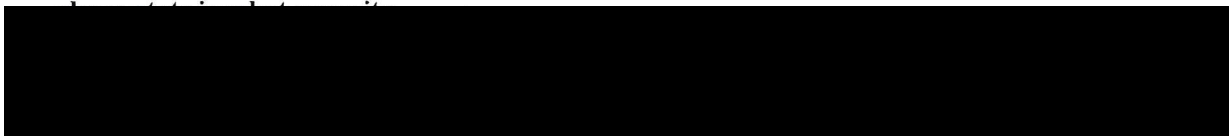

Date	24 th May 2018
Capacity	Licensing Assistant

Where the premises licence is jointly held, signature of 2nd applicant (the current premises licence holder) or 2nd applicant’s solicitor or other authorised agent (please read guidance note 14). **If signing on behalf of the applicant, please state in what capacity.**

Signature	
Date	
Capacity	

Contact name (where not previously given) and address for correspondence associated with this application (please read guidance note 15)

Hannah Loynds
Greene King Retailing Limited
Westgate Brewery

Post town	Bury St Edmunds	Post code	IP33 1QT
Telephone number (if any)	01284 714140		
If you would prefer us to correspond with you by e-mail, your e-mail address (optional) licensing@greeneking.co.uk			

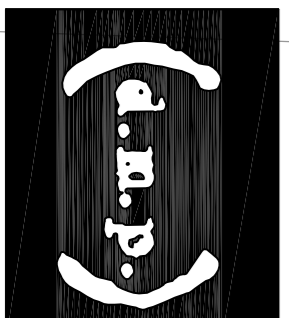

designmanagementpartnership
 8, Strada Street, Cardiff, CF10 5SR
 T +44(0)29 2064 4829
 F +44(0)29 2064 4831
 E mail@designmanagementpartnership.com

GROUND FLOOR PLAN
 scale 1:100 @ A1

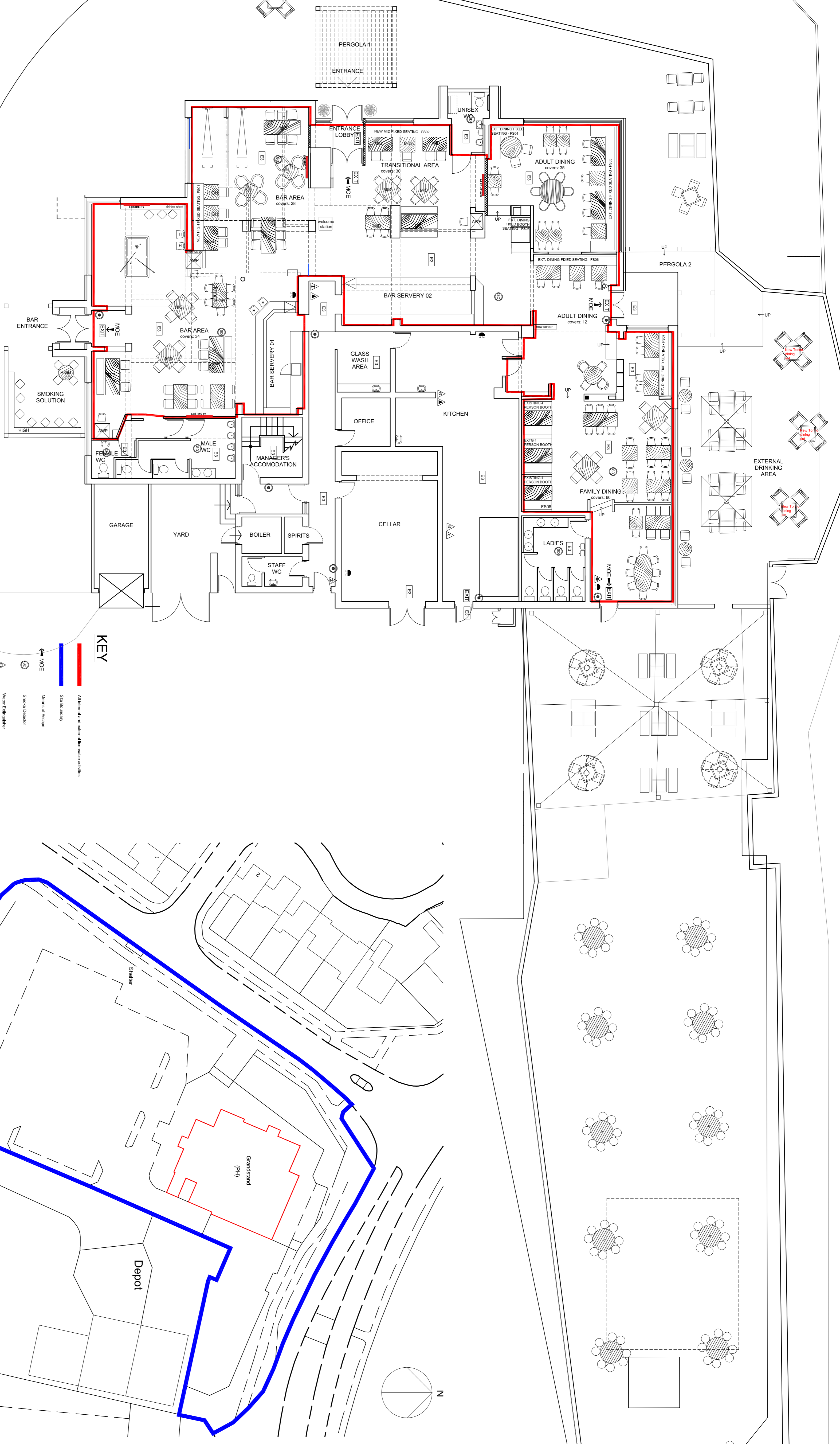

- KEY**
- All internal and external firewalls systems
 - Site Boundary
 - Means of Escape
 - MOE
 - Smoke Detector
 - Water Firefighting
 - EXIT
 - Emergency exit light (hour maintained with photogram)
 - Emergency light (hour non-maintained)
 - Manual Callpoint
 - Carbon Dioxide Firefighting
 - Foam Firefighting
 - Chemical Firefighting
 - Fire blanket in cabinet
 - Alarm bell
- AWP** Assumptions with Project architect

SITE LOCATION PLAN
 scale 1:500 @ A1



NOTE: Structural footings of the existing building and other existing structures in place. The new building is shown in red. The site is subject to conditions in the future as necessary and where applicable in liaison with the Fire Officer. Outline areas are to be used for the consumption of alcohol.

NO.	DATE	DESCRIPTION	BY	CHECKED	SCALE	STATUS	DATE	BY	FOR
1	17.05.18	Final drawings to be used for construction	PG	—	1:100	Approved	17.05.18	—	—
2	17.05.18	Final drawings to be used for construction	PG	—	1:100	Approved	17.05.18	—	—
3	17.05.18	Final drawings to be used for construction	PG	—	1:100	Approved	17.05.18	—	—

Scale	1:100
Drawn	PG
Checked	—
Date	17.05.18
Site	17.11.18
Project	250
Client	The Grandstand Hereford for Greene King
Architect	designmanagementpartnership
Contractor	—